

Bermondsey Huts

In accordance with the great respect for created things in the famous **Rule of St Benedict** (480-540), the monks of Worth Abbey like to share and make available to others the estate on which they live. Since the 1930's the monks have made the "Bermondsey Huts" available to groups of people, particularly children, who would benefit from a cheap holiday in the countryside. They were originally for parishes in South London, but now for any group that has a reasonable need, particularly youth, people



with learning difficulties and the physically challenged. Previous groups include: parishes, ethnic, family and youth groups, boys clubs, schools, students, choirs, hospitals, single-parent families, cyclists, Forest School, Scouts, Guides, Cubs, Brownies,., Duke of Edinburgh Expedition training, people with learning difficulties, physically challenged, artists and those seeking a religious retreat.

Many groups, companies, families and individuals have contributed time and material to the development and maintenance of the Huts for those who use them. Users are asked to respect their generosity and play their own part in the project by taking extra special care of the Huts and their fixtures and fittings and, perhaps, contributing to them for the benefit of other users.

What can we do there?

The Huts provide a great base for all sorts of country activities, as well as an optional close encounter with Environmental Education, Alternative Technology and country crafts. You can have a quiet, restful, lazy sort of time, soaking up the sun and enjoying the country air and just "camping", or you could go for energetic hikes, sporting activities, nature studies or learn about ecology and the environment. There are many good walks (and public houses) in this **Area of Outstanding Natural Beauty**. Local towns provide the usual attractions for sport and entertainment. Those who wish to include an explicitly religious dimension are invited to take part in the church life of the Benedictine Monastery that can be seen from the Huts, one mile across the valley to the North.

What do we need to bring?

As well as activity material, you will need to bring your own sleeping bags or bedding, towels, food, toilet paper, soap, tea towels, etc. If there are more than 10 in the group, you will need, tents, mattresses etc. for camping.

What will we find there?

You can think of the Huts either as very comfortable, "hard-roofed tents" or "very basic buildings" depending on your expectations! (See drawing for facilities available). The only electricity source on site is a solar-charged battery system (installed in September 2016) which runs the fridge, lighting and a couple of mains sockets

Please note: The sockets are very low power and only suitable for USB ports for charging mobiles. They should NOT be used for any other kind of electric appliances, motors or heaters.

There is LPG gas to run the cooker, and instant water heaters. There is a mains water supply, but it is not suitable for drinking, and is drained down in the winter.

If you are staying at the Huts and you find the water is drained down and shut off, then please do not attempt to turn the water back on as this will cause serious damage to the pipes and system.



Where are Worth Abbey and the Bermondsey Huts

Bermondsey Huts are one mile down 'Back Lane', which forms the Eastern Boundary of the Worth Abbey estate. The Huts are about where the 'W' of 'Worth Abbey' is on the map (right).

OS Map Ref: TQ 323 331

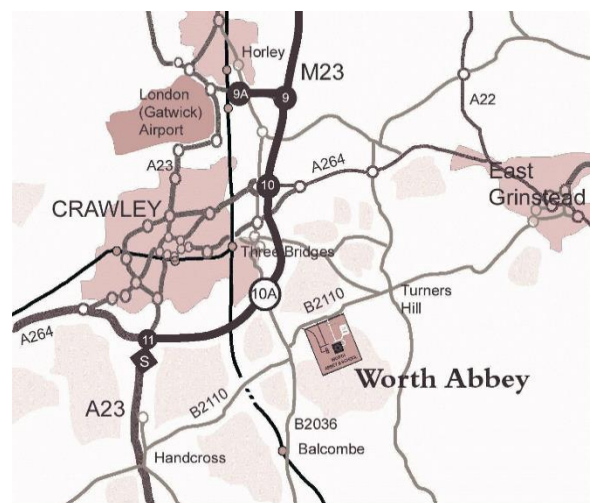
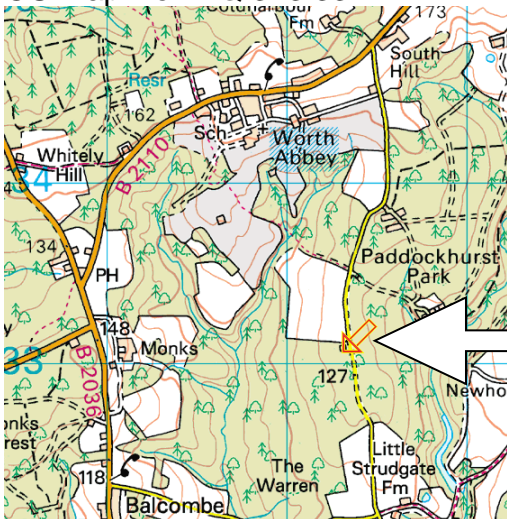

By Rail: Three Bridges Station (on the London to Brighton line) is 4 miles away. We advise taking a taxi as there is no direct bus route.

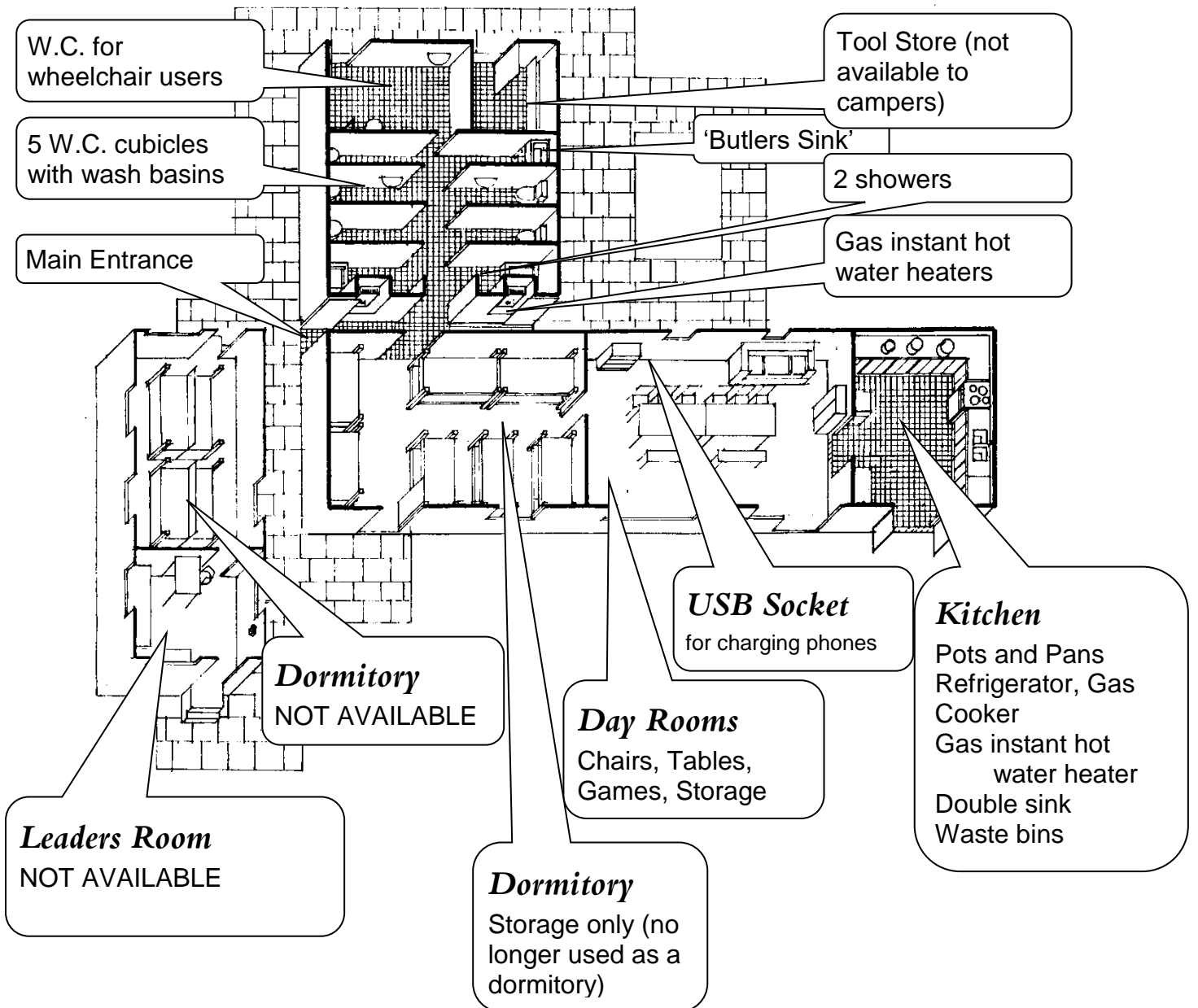
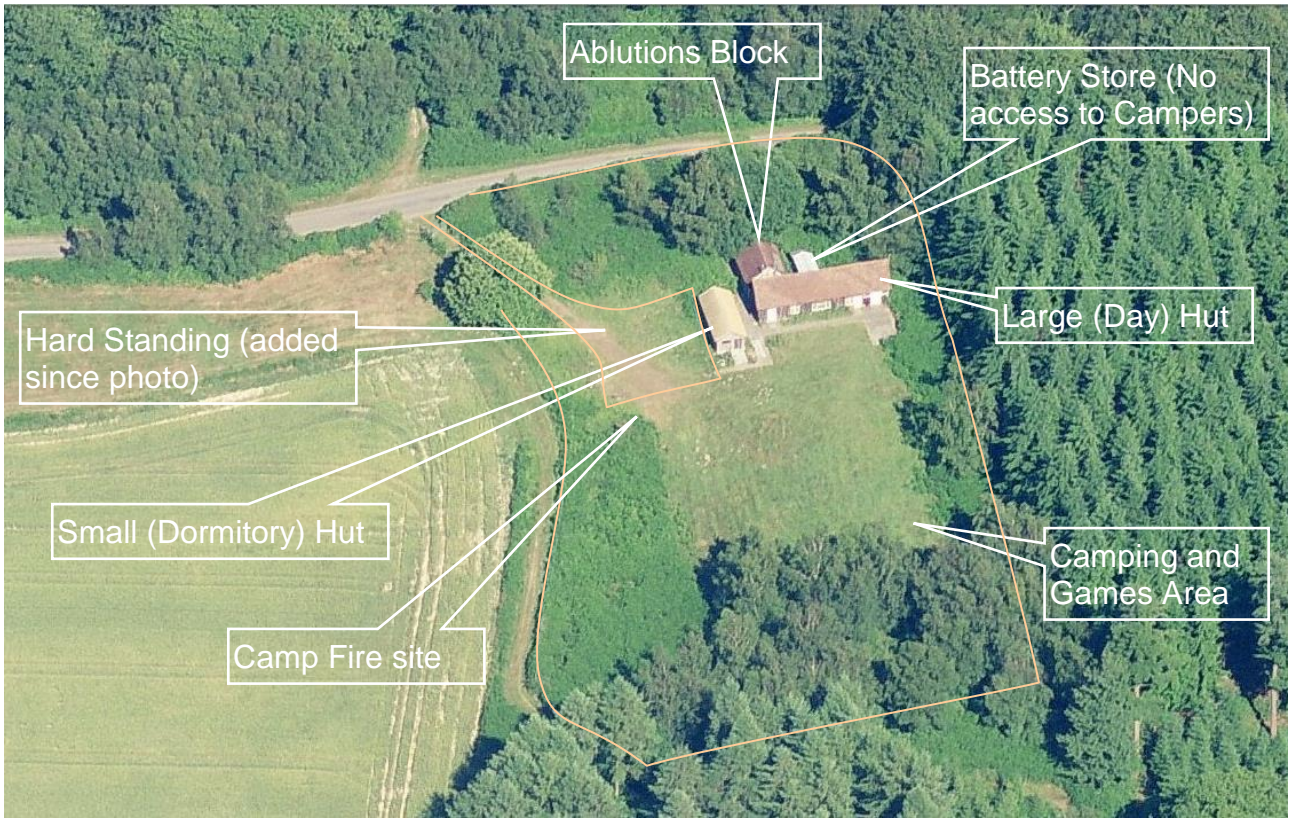

A few Musts

Group leaders must take full responsibility at all times for the effective supervision of their group and the safe use of all the facilities made available at the Huts. Because the Huts are in an area of commercial forestry and farming, all members of the group will be expected to follow the Country Code:

The Country Code

From a gentle stroll or relaxing picnic to a long-distance walk or heart-pumping adventure, the countryside provides every opportunity for enjoyment and relaxation. There are five sections of The Countryside Code dedicated to helping members of the public respect, protect and enjoy the countryside:

- Be safe, plan ahead and follow any signs
- Leave gates and property as you find them
- Protect plants and animals and take your litter home
- Keep dogs under close control
- Consider other people

If you follow the Countryside Code wherever you go, you'll get the best enjoyment possible and you'll help to protect the countryside now and for future generations.

How do we get there?

By road: see maps

By rail: The nearest British rail station is Three Bridges on the Brighton-Victoria line. We advise taking a taxi as there is no direct bus route.

What does it cost?

Because of the generosity of many individuals, communities, Trusts, Companies and organisations who have contributed towards the buildings and equipment, we are able to keep the cost to a minimum.

For 2021, the cost is £10.00 per person per night (inc VAT), and the deposit required is 10% or £100.

How do we book?

In the first instance, contact the *Bookings Secretary* to check available dates and make a provisional booking. Then simply complete a booking form and send it with the required deposit, to reach us at least one month before your provisional booking. You will be sent a confirmation of your booking and further details of the practical day to day use of the Huts and some useful checklists of what to bring and do. The balance may be paid during your stay at the Huts.

Contact details

The Bookings Secretary,
Worth Abbey † The Open Cloister,
Paddockhurst Road,
Turners Hill,
CRAWLEY,
West Sussex.
RH10 4SB

Tel (office hours): 01342 710318
Email: toc@worth.org.uk
Web: worth.co.uk/retreats/camping
OS Map Ref: TQ 323 331